

Township No. 7 South Range No. 36 East Willamette Meridian, Oregon.

49

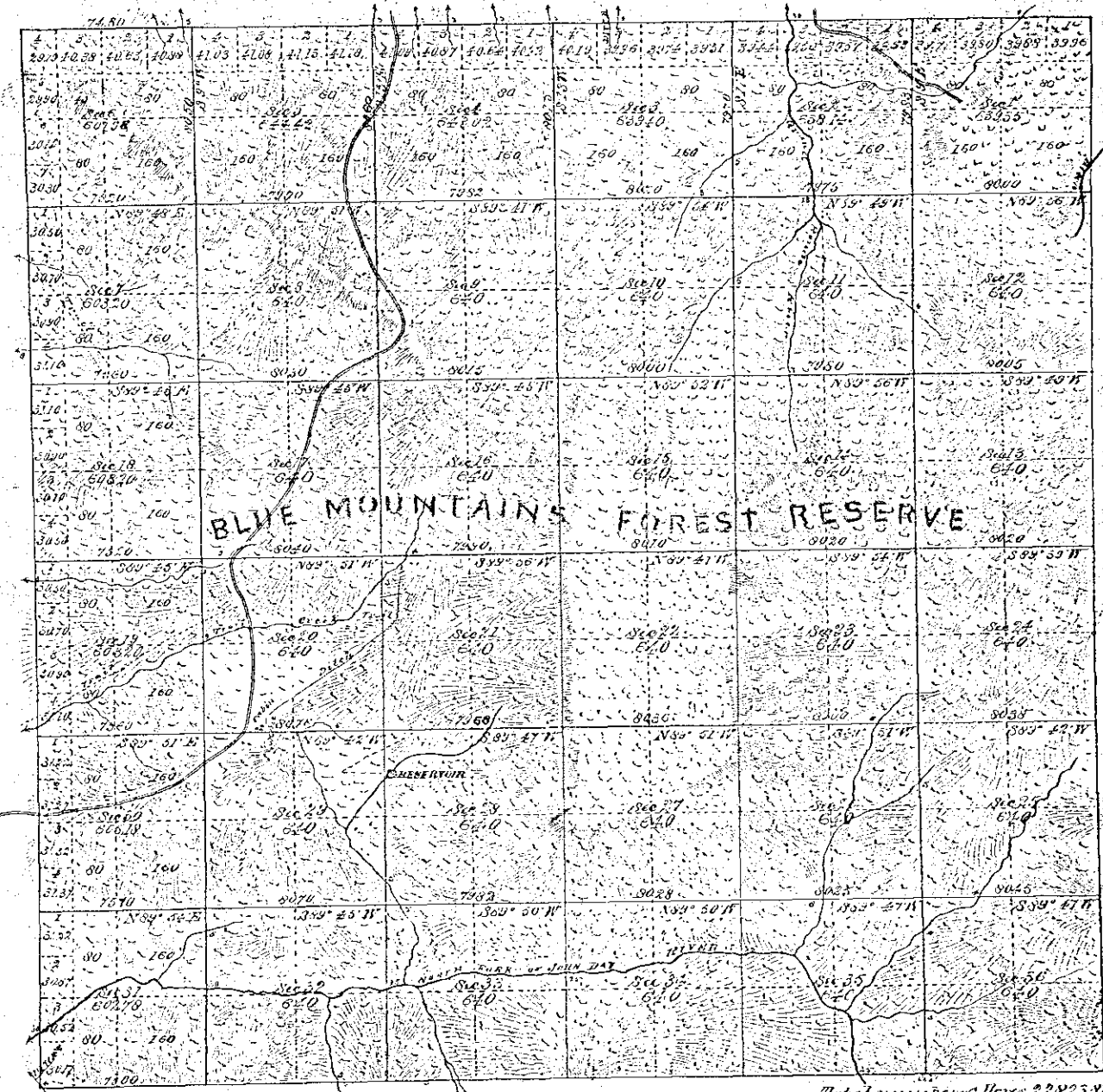

PREPARED BY THE HON. COMMISSIONER C. L. O. Sept. 11, 1884

SURVEYS DESIGNATED.	BY WHOM SURVEYED.	NO.	DATE OF CONTRACT.	Amount of Survey.	WHEN SURVEYED.	MEAN DECLINATION.
Township Series Subdivisions	Eugene P. McCune W. H. B. B.	399	July 2, 1884	50 61 53	May 26 & 23, 1885	15° 15' 30"
		492	Aug 22, 1883			

The above map of subdivisions of Township No. 7 South of Range No. 36 East of the Willamette Meridian, Oregon, is strictly conformable to the Field Notes of the survey thereof on file in this office, which have been examined and approved.

U. S. Surveyor-General's Office,
Portland, Oregon,

Sept. 1, 1884 James G. Tolman
Surveyor-General of Oregon

Wm. H. Johnson
Supervisor of Surveys

Antoinette J. Smith
Assistant Commissioner